









# BLENDING CUP AND BOWL Use and Care Instructions

Ascent and Venturist Series

## SYMBOLS

	Warning and Caution		Read and understand the owner's manual.
	Parts will become hot with extended use. NEVER touch the motor base drive socket or the drive spline in the blade base.		NEVER touch moving parts. Keep hands away from the drive spline and utensils out of the container.
	NEVER use the cup/bowl to heat ingredients or to blend hot liquids. NEVER use the cup/bowl (including the blade base or lids) in the microwave.		
	NEVER hold the cup/bowl while the appliance is blending. Keep hands away from the cup/bowl until the motor and blades stop completely.		

## SPECIFICATIONS

Height w/blade base:	Cup 9.8 inches / 24,9 cm Bowl 6.3 inches / 16,0 cm	Weight (Kit):	1.1 lbs / 500 g
Height:	Cup 8.0 inches / 20,3 cm Bowl 3.1 inches / 7,9 cm	Capacity:	Cup 20 oz / 600 ml Bowl 8 oz / 240 ml (US) 225 ml (Imperial)
Width:	Cup 4.5 inches / 11,4 cm Bowl 4.5 inches / 11,4 cm		



U.S. Patent: [vitamix.com/patents](http://vitamix.com/patents)

**VITA-MIX® CORPORATION**  
8615 Usher Road, Cleveland, Ohio 44138 U.S.A.  
Tel (International): 1.440.235.4840  
Technical Support: 1.800.848.2649  
Email: [service@vitamix.com](mailto:service@vitamix.com)

## IMPORTANT SAFEGUARDS

### **WARNING**



**Carefully read all instructions before using components for the first time. Save these instructions for future reference.**

**Place a clean, dry seal onto and then firmly tighten the blade base onto the cup/bowl BEFORE blending.**

**If the cup/bowl becomes unthreaded from the blade base during operation, turn the appliance OFF and wait until the motor and blades stop completely before attempting to remove the cup/bowl and blade base from the motor base.**

**NEVER fill the container with solids or liquids beyond the line marked "MAXIMUM CAPACITY" to avoid risk of injury.**



**NEVER touch moving parts. Keep hands and utensils out of containers and cups during blender operation. DO NOT insert fingers or utensils around the blades while the blades are spinning.**

**Ensure the motor has stopped completely and the appliance is unplugged before removing the container.**

**NEVER hold the cup/bowl while the appliance is blending. Keep hands away from the cup/bowl until the motor and blades stop completely.**



This product is intended for HOUSEHOLD USE ONLY and is not intended to be used for commercial purposes.

1. THE FAILURE TO FOLLOW ANY OF THE IMPORTANT SAFEGUARDS AND IMPORTANT INSTRUCTIONS FOR SAFE USE IS A MISUSE OF YOUR VITAMIX APPLIANCE THAT CAN VOID YOUR WARRANTY AND CREATE THE RISK OF SERIOUS INJURY.
2. The instructions appearing in this manual cannot cover every possible condition and situation that may occur. Common sense and caution must be practiced when operating and maintaining any appliance.
3. Strictly follow the care and cleaning instructions provided in this manual.
4. NEVER use components for anything other than their intended use.
5. This appliance is not intended for use by persons (including children) with reduced physical, sensory or mental capabilities, or lack of experience or knowledge, unless they have been given supervision or instruction concerning use of the appliance by a person responsible for their safety.
6. Remove and discard packaging materials and promotional labels before using components for the first time.
7. NEVER operate the appliance with loose, nicked, or damaged blades; replace immediately. Check the blades daily.
8. NEVER tighten the acorn nut on the top of the blade assembly. If loose, replace the blade assembly immediately.
9. NEVER place the components on or near a hot gas or electric burner, or where they could touch any other source of heat.
10. ALWAYS ensure components are completely and properly assembled before operation.
11. The blade assembly is very sharp. Handle carefully and keep out of reach of children.
12. ALWAYS ensure the appliance is unplugged from the power outlet before attempting to assemble any of the attachments.
13. NEVER use attachments other than those provided with the components or offered separately from Vitamix. The use of attachments, including preserving jars, not sold or recommended by Vitamix may cause fire, electric shock, or injury and will void the warranty.

## IMPORTANT SAFEGUARDS

- Alteration or modification of any part of the components, including the use of any part or parts that are not genuine authorized Vitamix parts, may cause fire, electric shock, or injury and will void your warranty.
- NEVER use the cup/bowl to heat ingredients or to blend hot liquids. Heated ingredients and liquids may create internal pressure which could cause the container to burst and cause injury.
- NEVER use the cup/bowl (including the blade base or lids) in the microwave.
- ALWAYS begin processing on the lowest speed setting, Variable Speed 1.
- NEVER touch surfaces that may be hot.
- NEVER leave any foreign object, such as spoons, forks, knives, or the lid plug in the cup/bowl as this will damage the blades and other components when starting the appliance and may cause injury.
- If during use, the sound of the appliance changes or if a hard or foreign object comes into contact with the blades, NEVER serve the food being made with the appliance.
- Keep hands, hair, clothing, and utensils away from all moving parts during operation to reduce the risk of severe injury to persons and/or damage to the appliance. A spatula may be used, but only when the appliance is not running.
- If the blend is not processing when blending dry, thick, or heavy mixtures, stop operation and use a spatula to dislodge the food. NEVER use fingers as the blending blade is sharp. Wipe the threads on the cup/ bowl and the blade base clean. Place a clean, dry seal onto the blade base before continuing to blend. Allow the motor to cool for 1 minute before turning the appliance back on.
- NEVER allow the blending blade to soak in water.
- NEVER use outdoors or on moving vehicles or boats.
- NEVER leave the working area when the appliance is in use.
- Parts will become hot with extended use. NEVER touch the motor base drive socket or the drive spline in the blade base.
- NEVER expose the cup/bowl to temperatures or ingredients over 210°F (99°C).
- NEVER operate the appliance without the centering pad installed properly underneath the cup/bowl.
- Ensure the cup/bowl and blade base are flush with the centering pad to ensure the drive spline is engaged with the drive socket before operating.
- NEVER place a blade assembly on the motor base unless assembled to the Vitamix cup/bowl to reduce the risk of injury.
- NEVER continuously use your appliance for more than 75 seconds with the cup/bowl.
- If the cup/bowl becomes warm to the touch, steams, or vents, immediately stop blending ingredients and turn off or unplug the appliance. Allow the container and ingredients to cool to room temperature before removing the blade base.
- When making nut butters or oil-based foods, DO NOT process for more than one minute after the mixture starts to circulate in the cup/bowl. Processing for longer periods can cause overheating.
- Regularly inspect the components for any damage. NEVER operate if damaged in any way or after the component malfunctions. Immediately cease use of the component and visit [www.vitamix.com](http://www.vitamix.com) or call Vitamix Household Technical Support at 1.800.848.2649 (International: 1.440.235.4840) for examination, repair, or adjustment.
- Any repair, servicing, or replacement of parts must be performed by Vitamix or a Vitamix authorized service representative.
- SAVE THESE INSTRUCTIONS.**

# ! WARNING



NEVER use the cup/bowl to blend hot liquids. Heated ingredients and liquids may create internal pressure which could cause the container to burst and cause injury.

If the cup/bowl becomes unthreaded from the blade base during operation, turn the appliance OFF and wait until the motor and blades stop completely before attempting to remove the cup/bowl and blade base from the motor base.



NEVER touch moving parts. Keep hands away from the drive spline and utensils out of the container.

NEVER fill the container with solids or liquids beyond the line marked "MAXIMUM CAPACITY" to avoid risk of injury.

NEVER hold the cup/bowl while the appliance is blending. Keep hands away from the cup/bowl until the motor and blades stop completely.



1. Remove the blade base seal.
2. Wash the seal with soap and water.
3. Rinse the seal thoroughly.
4. Place a clean, dry seal onto the blade base threads.

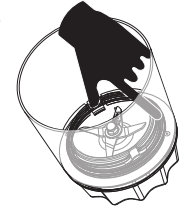
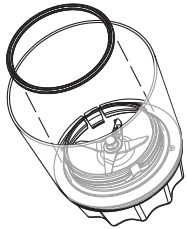

5. Add ingredients to the cup/bowl in the order they appear in the recipe or follow the Load Order Illustration below.
6. Install the blade base onto the cup/bowl and rotate at least 3/4 to 1 full turn clockwise until tight.
7. Tighten the base and cup/bowl together until the arrow on the blade base is within the bracket on the cup/bowl label.

NEVER blend hot liquids!

- 
- Liquids
  - Dry Goods
  - Leafy Greens
  - Fruits & Veggies
  - Ice & Frozen Ingredients

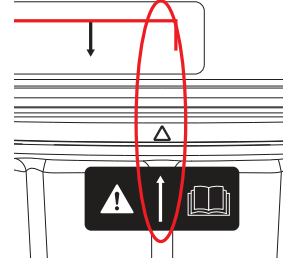
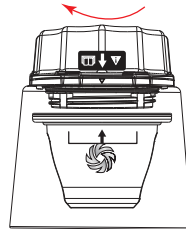

OR

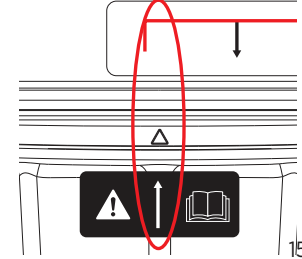

## USE

8. Place the cup/bowl assembly onto the motor base.

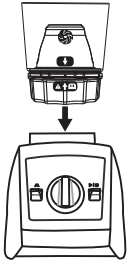

9. Follow the recipe instructions.



10. Press the Start/Stop Switch to turn on the appliance or select the appropriate program setting.

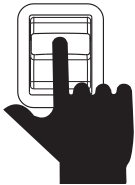

11. If the mixture stops circulating:
- Press the Start/Stop Switch to turn off the appliance.
  - Wait until the blades stop completely before removing the cup/bowl assembly from the motor base.
  - Turn the cup/bowl assembly over.
  - Remove the blade base from the cup/bowl assembly by rotating it counter-clockwise.
  - Stir the ingredients using a Vitamix Blade Scraper or spatula.
  - Add liquid if necessary.
  - Remove the blade base seal.
  - Wipe the threads on the cup/bowl and the blade base clean.
  - Place a clean, dry seal onto the blade base threads.
  - Reassemble the blade base to the cup/bowl and onto the motor base (see Steps 6-8).

12. After blending is complete, press the Start/Stop Switch to turn off the appliance. If using a program, the appliance will turn off after the program is complete.

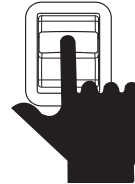

13. Wait until the blades stop completely before removing the cup/bowl assembly from the motor base.

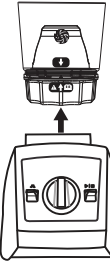

14. Turn the cup/bowl assembly over.

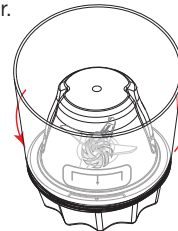

15. Remove the blade base from the cup/bowl assembly by rotating it counter-clockwise.

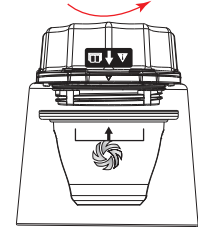

16. If necessary, use a Vitamix Blade Scraper or spatula to remove salsa, jelly, jam, peanut butter, and other thick ingredients from under the blades.

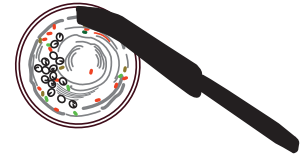

17. Enjoy your blend!

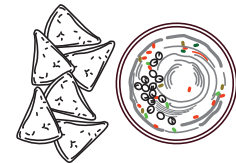

# ! WARNING



NEVER use the cup/bowl to blend hot liquids. Heated ingredients and liquids may create internal pressure which could cause the container to burst and cause injury.  
The seals must be washed and dried after each use to avoid ingredient build-up.



The blending blade assembly is very sharp. Handle carefully and keep out of reach of children.  
The blade base threads must be washed and dried after each use to avoid ingredient build-up.

## Dishwasher

All components, including the seals, are top-rack dishwasher safe.

## Hand Washing

- Place a clean, dry seal onto the blade base threads. The seal should fit snugly and evenly around the bottom thread.

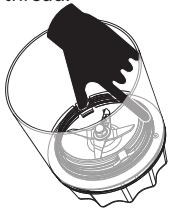

- Fill the cup/bowl half-full with **COLD** water and two drops of dishwashing liquid.



- Install the blade base onto the cup/bowl and rotate at least 3/4 to 1 full turn clockwise until tight.

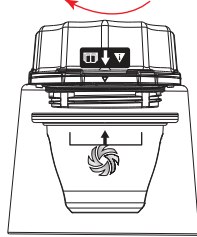

- Tighten together until the arrow from the blade base is within the bracket on the cup/bowl label.

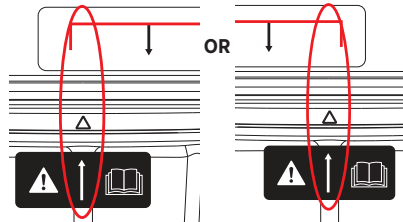

- Place the cup/bowl assembly onto the motor base.

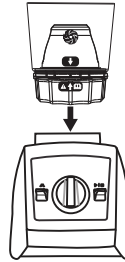

- Press the Start/Stop Switch to turn on the appliance or select the self-clean program. If the appliance does not have self-clean, proceed to Step 7. If using the self-clean program, proceed to Step 11.

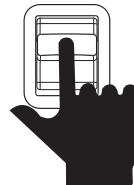

- Slowly increase the Variable Speed Dial to 10.

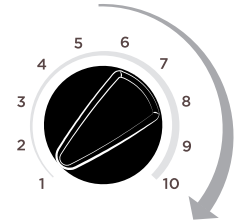

- Run the appliance for 35 to 60 seconds.

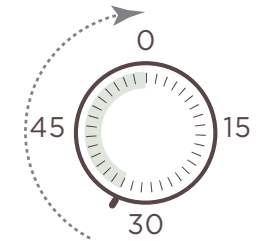

## CARE

9. Rotate the Variable Speed Dial back to Variable Speed 1.

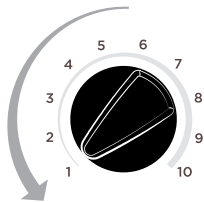

10. After blending is complete, press the Start/Stop Switch to turn off the appliance.



11. Wait until the blades stop completely before removing the cup/bowl assembly from the motor base.

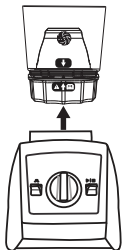

12. Turn the cup/bowl assembly over.

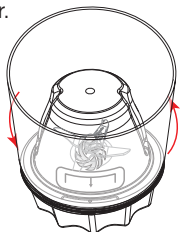

13. Remove the blade base from the cup/bowl assembly by rotating it counter-clockwise.

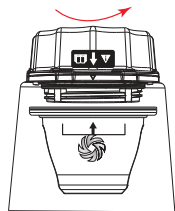

14. Rinse and drain all pieces.



### Sanitizing with Bleach:

1. First perform the "Cleaning with Water" instructions.
2. Then repeat the "Cleaning with Water" instructions but add 1-1/2 teaspoons of liquid bleach to 16 oz. (473 ml) of water.
3. Allow the mixture to stand in the container for an additional 1-1/2 minutes.
4. Pour the bleach mixture out. Allow container to air dry. DO NOT rinse after sanitizing.

### Sanitizing with Vinegar:

1. First perform the "Cleaning with Water" instructions.
2. Then repeat the "Cleaning with Water" instructions but use 16 oz. (473 ml) of vinegar for every 16 oz. (473 ml) of water.
3. Allow the mixture to stand in the container for an additional 3 full minutes. Total contact time of the vinegar solution in the container should equal 5 minutes.
4. Pour the vinegar solution out of the container over the inside surface of the 2-part lid.
5. Repeat the sanitizing procedure a second time (Steps 2-4).
6. Allow the container and lid to air dry. DO NOT rinse after sanitizing. If desired, rinse immediately before next use.

# WARRANTY AND SERVICE

## 3-YEAR FULL WARRANTY ON SEPARATELY SOLD CUPS AND COMPONENTS

### 1. WHAT IS COVERED.

Vita-Mix Corporation ("Vitamix") warrants that the cups ("cup/bowl"), lid, blade base and seals (collectively and individually referred to as "Component") that is purchased separately from a blender motor base will be free from defects in material or workmanship and will withstand wear and tear from ordinary household use for 3 years from the earlier of the date of purchase or date of delivery as permitted by law. Vitamix will, within 30 days of receipt of the returned product, repair the failed Cup or Component free of charge. If, in Vitamix's sole discretion, the failed Cup or Component cannot be repaired, Vitamix will elect to either (A) replace the Cup or Component free of charge or (B) refund the full purchase price to the owner, unless Vitamix receives prior written notice of the owner's preference.

### 2. WHAT IS NOT COVERED.

This Warranty applies only to owners for ordinary household use. This Warranty does not cover cosmetic changes that do not affect performance, such as discoloration or the effects of the use of abrasives or cleaners or food build up. This Warranty is only valid if the Cup and/or Component is used in accordance with the instructions, warnings and safeguards contained in the owner's manual.

**Grinding certain herbs and spices in the container/cup will result in cosmetic marring of the container/cup and may cause the blades to wear prematurely. Traces of sand, coarse gritty and abrasive herbs will also cause the blades to wear prematurely. Herbs may contain volatile oils, cause the container/cup to retain the oils and cause permanent discoloration. Your container/cup and blades are not covered under the Vitamix warranty under these circumstances.**

Vitamix will not be responsible for the cost of any unauthorized warranty repairs.

**REPAIR, REPLACEMENT OR REFUND OF THE PURCHASE PRICE ARE THE EXCLUSIVE REMEDIES OF PURCHASER AND THE SOLE LIABILITY OF VITAMIX UNDER THIS WARRANTY. NO EMPLOYEE OR REPRESENTATIVE OF VITAMIX IS AUTHORIZED TO MAKE ANY ADDITIONAL WARRANTY OR ANY MODIFICATION TO THIS WARRANTY WHICH MAY BE BINDING UPON VITAMIX. ACCORDINGLY, PURCHASER SHOULD NOT RELY UPON ANY ADDITIONAL STATEMENTS MADE BY ANY EMPLOYEE OR REPRESENTATIVE OF VITAMIX. IN NO EVENT, WHETHER BASED ON CONTRACT, INDEMNITY, WARRANTY, TORT (INCLUDING NEGLIGENCE), STRICT LIABILITY OR OTHERWISE, SHALL VITAMIX BE LIABLE FOR ANY SPECIAL, INDIRECT, INCIDENTAL OR CONSEQUENTIAL DAMAGES, INCLUDING, WITHOUT LIMITATION, LOSS OF PROFIT OR REVENUE.**

Some states do not allow limits on warranties. In such states, the above limitations may not apply to you. Outside the U.S.A. and Canada, other warranties may apply. This warranty gives you specific legal rights, and you may also have other rights which vary from state to state.

### 3. WHAT VOIDS THIS WARRANTY.

Abuse, misuse, negligent use, alteration of the Cup or Component or motor base, exposure to abnormal or extreme conditions, or failure to follow the operating instructions, will void this Warranty. The Warranty is also void if repairs to the machine, Cup, Component or motor base are performed by someone other than Vitamix or an authorized Vitamix Service Provider or if any part subject to this Warranty is used in combination with a motor base or container that is not expressly authorized by Vitamix.

### 4. HOW TO OBTAIN RETURN AUTHORIZATION UNDER THIS WARRANTY.

In the event the Cup or Component needs service or repair, please call Vitamix Household Technical Support at 1.800.848.2649. You will be asked to provide a date of purchase and proof of purchase for any product that has not been registered with Vitamix. For product subject to this Warranty you will be provided with a return authorization number, up-to-date shipping instructions and a pre-paid return pick up label. Vitamix will pay standard shipping costs on the return of a Container or Container Component for warranty service and repair and for return shipment of the product to you after the warranty repair or replacement. Purchaser is responsible for the costs of special shipping requests. Within the U.S.A. and Canada, this Warranty is honored directly through the Vita-Mix® Corporation. For a list of Vitamix Distributors in your country, visit [https://www.vitamix.com/vr/en\\_us/international-support](https://www.vitamix.com/vr/en_us/international-support).

You will be deemed to have accepted the returned product "as is" upon delivery unless you notify Vitamix of any problem, including shipment damage, within 48 hours of delivery.

United States  
Vita-Mix® Corporation  
8615 Usher Road  
Cleveland, Ohio 44138-2199  
1.800.848.2649  
service@vitamix.com

Canada  
Vita-Mix® Corporation  
200-1701 Shepherd Street East  
Windsor, Ontario N8Y 4Y5  
1.800.848.2649  
service@vitamix.com

México  
Vita-Mix Electrodomésticos, S. de R.L. de C.V.  
Artemio del Valle Arizpe No. 16, Piso 2  
Col. Del Valle, Del. Benito Juárez  
Ciudad de México 03100 México  
Teléfono de Atención al Cliente: 01 800 436 0110  
Tel: (+52) 55 4738 6258